

Screws, Nuts, Enclosures

CAPS – C Series (Non-Threaded — Tubing)

MATERIAL: Soft Vinyl (U.V. Stabilized and Self-extinguishing).

COLOR: Yellow

APPLICATION: Designed to fit outside diameter of tubing sizes listed. Rubber-like material enables parts to fit irregular shapes.

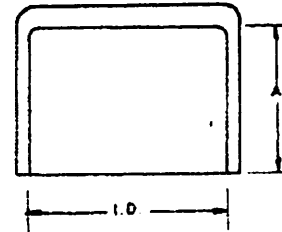

PART NO.	TUBE SIZE	A	APPROX. WGT. PER M (IN LBS.)	PART NO.
C-002	1/16"	1/2"	.7	C-002
C-001	5/64"	1/2"	.4	C-001
C-01	3/32"	1/2"	.7	C-01
C-02	7/64"	1/2"	.4	C-02
C-1	1/8"	19/32"	.9	C-1
C-2	5/32"	19/32"	1.1	C-2
C-3	3/16"	19/32"	1.3	C-3
C-5	1/4"	19/32"	1.8	C-5
C-7	5/16"	19/32"	2.0	C-7
C-9	3/8"	19/32"	2.9	C-9
C-11	7/16"	19/32"	3.3	C-11
C-12	15/32"	19/32"	3.8	C-12
C-13	1/2"	19/32"	3.7	C-13
C-14	17/32"	5/8"	3.7	C-14
C-15	9/16"	5/8"	4.6	C-15
C-16	19/32"	5/8"	4.6	C-16
C-17	5/8"	5/8"	5.3	C-17
C-18	21/32"	5/8"	5.1	C-18
C-19	11/16"	5/8"	5.1	C-19
C-200	23/32"	5/8"	6.0	C-200
C-21	3/4"	5/8"	6.2	C-21
C-23	13/16"	5/8"	6.4	C-23
C-201	27/32"	5/8"	6.6	C-201
C-24	7/8"	5/8"	7.3	C-24
C-27	1"	5/8"	8.2	C-27
C-230	1-1/16"	5/8"	9.5	C-230
C-232	1-1/8"	5/8"	10.8	C-232
C-233	1-5/32"	1/2"	7.7	C-233
C-234	1-3/16"	5/8"	8.8	C-234
C-235	1-7/32"	1/2"	7.7	C-235
C-236	1-1/4"	5/8"	11.2	C-236
C-336	1-1/4"	7/8"	16.0	C-336
C-238	1-5/16"	5/8"	10.4	C-238
C-240	1-3/8"	5/8"	12.3	C-240
C-340	1-3/8"	7/8"	22.7	C-340
C-242	1-7/16"	5/8"	13.4	C-242
C-244	1-1/2"	5/8"	13.0	C-244
C-344	1-1/2"	7/8"	25.6	C-344
C-248	1-5/8"	5/8"	15.2	C-248
C-348	1-5/8"	7/8"	27.3	C-348
C-252	1-3/4"	5/8"	17.6	C-252
C-352	1-3/4"	7/8"	30.2	C-352
C-256	1-7/8"	5/8"	20.1	C-256
C-356	1-7/8"	7/8"	34.3	C-356
C-260	2"	5/8"	21.8	C-260
C-460	2"	1"	39.9	C-460
C-462	2-1/8"	1"	42.3	C-462
C-264	2-1/4"	5/8"	26.0	C-264
C-464	2-1/4"	1"	45.4	C-464
C-466	2-3/8"	1"	48.5	C-466

Nylomatic

Screws, Nuts, Enclosures

CAPS - C Series

(Non-Threaded — Tubing — Continued)

PART NO.	TUBE SIZE	A	APPROX. WGT. PER M (IN LBS.)	PART NO.
C-268	2-1/2"	5/8"	31.3	C-268
C-468	2-1/2"	1"	56.0	C-468
C-470	2-5/8"	1"	55.5	C-470
C-272	2-3/4"	5/8"	36.1	C-272
C-472	2-3/4"	1"	57.5	C-472
C-474	2-7/8"	1"	64.1	C-474
C-276	3"	5/8"	40.1	C-276
C-476	3"	1"	67.2	C-476
C-480	3-3/4"	1-1/8"	100.7	C-480

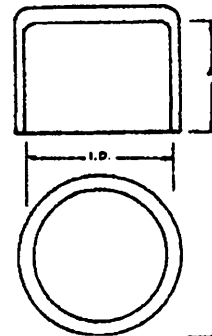

CAPS - LC Series

(Non-Threaded — 1/4" Lubrication Fittings)

MATERIAL: Soft Vinyl (U.V. Stabilized and Self-Extinguishing)

COLOR: Yellow

APPLICATION: Designed to fit lubrication fittings, to protect them against the penetration of dirt and moisture.

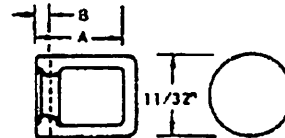

PART NO.	A	B	WGT. PER M (IN LBS.)
LC-392	11/32"	1/16"	1.4
LC-400	9/16"	3/32"	2.0

CAPS - M Series

(Partially Threaded — Machine Screw)

MATERIAL: Soft Vinyl (U.S. Stabilized and Self-Extinguishing)

COLOR: Yellow

APPLICATION: These flexible vinyl caps can be screwed on or pushed on and offer a positive grip. They can be easily removed by unscrewing.

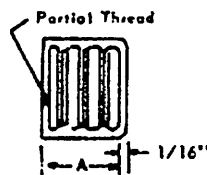

PART NO.	DESIGNED TO FIT	A
M-811	7/16"-20	19/32"
M-813	1/2"-20	19/32"
M-815	9/16"-18	5/8"
M-816	9/16"-20	5/8"
M-817	5/8"-18	5/8"
M-818	5/8"-24	5/8"
M-821	3/4"-16	5/8"
M-825	7/8"-18	5/8"
M-827	1"-20	5/8"

Nylomatic

Screws, Nuts, Enclosures

CAPS – RRO Series

(Non-Threaded — IPS Pipe — Open End)

MATERIAL: Polyethylene

COLOR: Coded: Black — Half-Inch Sizes 1/2" -

1-1/2" - 2-1/2" - 3-1/2"

All Sizes 8" through 42"

Red — Quarter Inch Sizes 3/4" - 1-1/4"

Blue — Full Inch Sizes 1" - 2" - 3" - 4" - 5" - 6"

APPLICATION: Designed to protect threads and pipe ends of the IPS pipe sizes listed below. They are molded with ridged interior walls for positive gripping power.

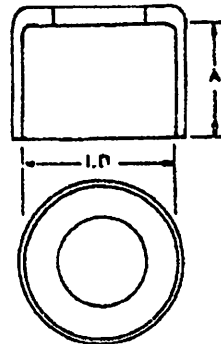

PART NO.	NPT SIZE	A	ID	CARTON *QUANTITIES	WGT. PER CARTON (IN LBS.)
RRO-1/2	1/2"	.771	.824	8300	35
RRO-3/4	3/4"	.793	1.038	5500	30
RRO-1	1"	.986	1.306	2800	27
RRO-1-1/4	1-1/4"	.931	1.644	2000	28
RRO-1-1/2	1-1/2"	.942	1.855	1500	24
RRO-2	2"	1.138	2.346	750	18
RRO-2-1/2	2-1/2"	1.502	2.865	432	22
RRO-3	3"	1.683	3.487	264	17
RRO-3-1/2	3-1/2"	1.741	3.960	198	18
RRO-4	4"	1.671	4.477	154	16
RRO-5	5"	1.800	5.530	126	19
RRO-6	6"	1.972	6.605	75	14

The Following Larger Sizes Available by Special Order

PART NO.	NPT SIZE	MINIMUM ORDER QUANTITY
RRO-8	8"	50 Pieces
RRO-10	10"	50 Pieces
RRO-12	12"	50 Pieces
RRO-14	14"	25 Pieces
RRO-16	16"	25 Pieces
RRO-18	18"	25 Pieces
RRO-20	20"	25 Pieces
RRO-22	22"	25 Pieces
RRO-24	24"	10 Pieces
RRO-26	26"	10 Pieces
RRO-28	28"	10 Pieces
RRO-30	30"	10 Pieces
RRO-32	32"	10 Pieces
RRO-34	34"	10 Pieces
RRO-36	36"	10 Pieces
RRO-42	42"	10 Pieces

*QUANTITIES LESS THAN STANDARD PACKAGE ADD 15%

Nylomatic

Screws, Nuts, Enclosures

CAPS – RRC Series

(Non-Threaded — IPS Pipe — Open End)

MATERIAL: Polyethylene

COLOR: Coded: Black — Half-Inch Sizes 1/2" - 1-1/2" - 2-1/2" - 3-1/2"

All Sizes 8" through 42"

Red — Quarter Inch Sizes 3/4" - 1-1/4"

Blue — Full Inch Sizes 1" - 2" - 3" - 4" - 5" - 6"

APPLICATION: Designed fit outside diameters of IPS pipe — either threaded or non-threaded. They are designed to protect threads and pipe ends and to keep foreign materials out of the pipe during transit. Parts are molded with rigid interior walls for positive gripping power.

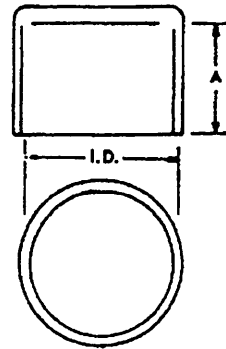

PART NO.	NPT SIZE	A	ID	CARTON *QUANTITIES	WGT. PER CARTON (IN LBS.)
RRC-1/2	1/2"	.771	.824	8300	42
RRC-3/4	3/4"	.793	1.038	5500	34
RRC-1	1"	.986	1.306	2800	34
RRC-1-1/4	1-1/4"	.931	1.644	2000	29
RRC-1-1/2	1-1/2"	.942	1.855	1500	34
RRC-2	2"	1.138	2.346	750	30
RRC-2-1/2	2-1/2"	1.502	2.865	432	25
RRC-3	3"	1.683	3.487	264	22
RRC-3-1/2	3-1/2"	1.741	3.960	198	23
RRC-4	4"	1.671	4.477	154	22
RRC-5	5"	1.800	5.530	99	18
RRC-6	6"	1.972	6.605	60	17

The Following Larger Sizes Available by Special Order

PART NO.	NPT SIZE	MINIMUM ORDER QUANTITY
RRC-8	8"	50 Pieces
RRC-10	10"	50 Pieces
RRC-12	12"	50 Pieces
RRC-14	14"	25 Pieces
RRC-16	16"	25 Pieces
RRC-18	18"	25 Pieces
RRC-20	20"	25 Pieces
RRC-22	22"	25 Pieces
RRC-24	24"	10 Pieces
RRC-26	26"	10 Pieces
RRC-28	28"	10 Pieces
RRC-30	30"	10 Pieces
RRC-32	32"	10 Pieces
RRC-34	34"	10 Pieces
RRC-36	36"	10 Pieces
RRC-42	42"	10 Pieces

*QUANTITIES LESS THAN STANDARD PACKAGE ADD 15%

Nylomatic

Screws, Nuts, Enclosures

CAPS - M Series (Threaded — Machine Screw)

MATERIAL: Acetate

COLOR: Yellow

APPLICATION: Caps will fit NS and NF Class 1-2-3 standard threads. Go-Gage only. Caps are ribbed for easy handling and are impervious to oils, greases, alkalies and other common corrodents...cleanly threaded for positive protection against dirt, dust and contaminants.

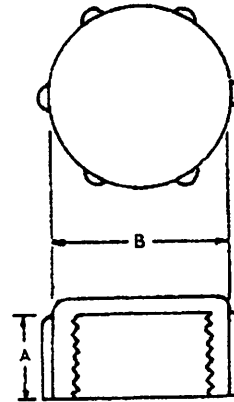

PART NO.	THREAD SIZE	A	B	WGT. PER M (IN LBS.)
M-161	1/4"-28	5/16"	3/8"	1.5
M-163	5/16"-24	3/8"	7/16"	2.6
M-164	3/8"-24	3/8"	1/2"	3.1
M-165	3/8"-32	3/8"	1/2"	3.1
M-167	7/16"-20	3/8"	19/32"	4.4
M-170	1/2"-20	3/8"	11/16"	6.1
M-171	1/2"-28	7/16"	11/16"	6.1
M-173	9/16"-18	3/8"	3/4"	6.1
M-206	9/16"-18	9/16"	3/4"	9.0
M-174	9/16"-20	3/8"	3/4"	6.1
M-176	5/8"-18	7/16"	13/16"	8.6
M-202	5/8"-18	9/16"	13/16"	10.2
M-178	5/8"-24	7/16"	13/16"	8.6
M-181	3/4"-16	7/16"	15/16"	11.0
M-220	3/4"-16	11/16"	15/16"	14.0
M-183	3/4"-20	1/2"	15/16"	8.0
M-186	7/8"-14	7/16"	1-1/16"	13.6
M-604	7/8"-14	11/16"	1-1/16"	11.8
M-187	7/8"-18	7/16"	1-1/16"	13.6
M-188	7/8"-20	7/16"	1"	10.4
M-244	1"-14	1/2"	1-5/32"	12.5
M-194	1"-20	1/2"	1-3/16"	14.8
M-229	1-1/16"-12	1/2"	1-1/4"	15.0
M-232	1-1/8"-18	1/2"	1-9/32"	13.7
M-230	1-1/4"-12	1/2"	1-1/2"	22.0
M-234	1-1/4"-18	1/2"	1-7/16"	20.0
M-237	1-1/2"-18	9/16"	1-11/16"	26.5
M-261	1-7/8"-12	9/16"	2-1/16"	37.0
M-485	2"-18	9/16"	2-3/16"	39.0

Nylomatic

Screws, Nuts, Enclosures

CAPS - M Series (Threaded-Machine Screw)

MATERIAL: Polyethylene

COLOR: Red

APPLICATION: Caps will fit NS and NF Class

1-2-3 standard threads. Caps are ribbed for easy handling.

PART NO.	THREAD SIZE	A	WGT. PER M (IN LBS.)
M-312	7/16"-20	.531	2.0
M-316	1/2"-20	.531	1.8
M-320	9/16"-18	.531	2.5
M-322	5/8"-18	.533	2.0
M-328	3/4"-16	.687	3.5
M-330	7/8"-14	.812	4.6
M-332	7/8"-18	.750	4.0
M-335	1-1/16"-12	.750	4.6

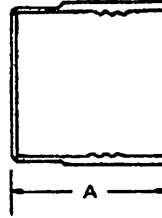

CAPS - PC Series (Threaded — Pipe Thread)

MATERIAL: Acetate

COLOR: Yellow

APPLICATION: Caps will fit NPT standard pipe threads. Caps are ribbed for easy handling.

PART NO.	THREAD SIZE	A	B	WGT. PER M (IN LBS.)
PC-151	1/8"	3/8"	17/32"	4.2
PC-152	1/4"	3/8"	11/16"	5.9
PC-153	3/8"	7/16"	27/32"	8.0
PC-154	1/2"	7/16"	1-1/16"	16.0
PC-155	3/4"	1/2"	1-1/4"	17.0
PC-156	1"	1/2"	1-1/2"	21.0
PV-157	1-1/4"	1/2"	1-13/16"	26.0

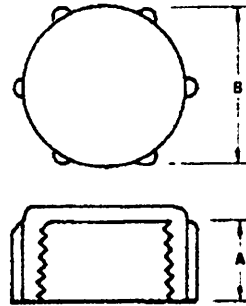

CAPS - FTC Series (Non-Threaded — Tubing)

Material: Polyethylene

COLOR: Red

APPLICATION: Designed to fit thread size, or diameter shown. Caps have flange for easy handling.

PART NO.	A — TO CAP THREAD SIZE OR DIAMETER	B	C	APPROX. WGT PER M (IN LBS.)
FTC-4	1/4"	.62	.40	1.0
FTC-6	3/8"	.65	.53	1.4
FTC-7	7/16"	.59	.57	1.7
FTC-10	5/8"	.84	.76	3.1
FTC-11	11/16"	.84	.83	3.3
FTC-12	3/4"	.88	.90	3.7
FTC-14	7/8"	.84	1.02	4.5

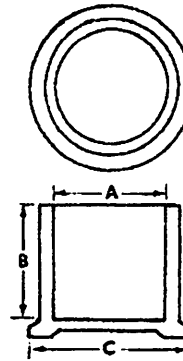

Nylomatic

Screws, Nuts, Enclosures

Plugs – P Series (Threaded — Pipe Thread — Knurled Head)

MATERIAL: Acetate

COLOR: Yellow

APPLICATION: Plugs will fit NPT pipe threads heads are knurled for easy handling.

PART NO.	THREAD SIZE	A	WGT. PER M (IN LBS.)
P-40	1/8"	3/8"	2.0
P-41	1/4"	3/8"	3.0
P-42	3/8"	3/8"	6.2
P-43	1/2"	3/8"	9.4
P-44	3/4"	3/8"	14.7
P-45	1"	3/8"	23.0
P-46	1-1/4"	3/8"	37.5
P-47	1-1/4"	1/2"	29.5
P-48	1-1/2"	1/2"	37.7
P-49	2"	1/2"	47.0

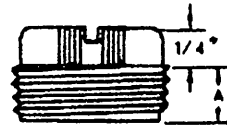
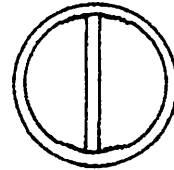

Plugs – P Series (Threaded — Pipe Thread — Square Head)

MATERIAL: Polyethylene

COLOR: Red

APPLICATION: Designed to fit NPT standard pipe threads. The square head design is adaptable to either hand or machine tightening.

PART NO.	THREAD SIZE	A	B	C	WGT. PER M (IN LBS.)
P-20	1/8"	3/8"	1/4"	1/4"	1.6
P-21	1/4"	3/8"	1/4"	5/16"	2.3
P-22	3/8"	3/8"	1/4"	3/8"	3.4
P-23	1/2"	3/8"	1/4"	7/16"	4.8
P-24	3/4"	3/8"	1/4"	5/8"	5.6
P-25	1"	3/8"	1/4"	3/4"	7.0

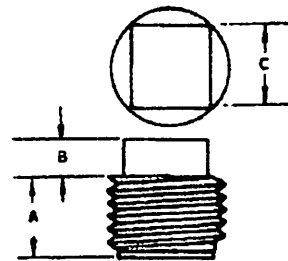

Plugs – P Series (Threaded — Pipe Thread — Square Head with Wiring Hole)

MATERIAL: Acetate

COLOR: Yellow

APPLICATION: Plugs will fit NPT standard pipe threads.

PART NO.	THREAD SIZE	A	B	WGT. PER M (IN LBS.)
P-503	1/4"	3/8"	3/8"	3.0
P-581	3/8"	3/8"	7/16"	5.0
P-582	1/2"	3/8"	1/2"	7.0

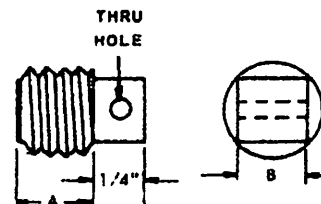

Nylomatic

Screws, Nuts, Enclosures

Plugs - DS Series (Threaded — Dummy Spark)

Material: Acetate

COLOR: Yellow

Go-Gage only.

APPLICATION: Designed to fit threaded opening for spark plug.

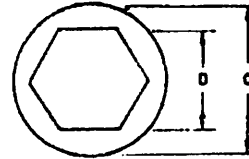
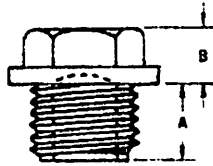

PART NO.	THREAD SIZE	A	B	C	D	WGT. PER M (IN LBS.)
DS-217	14 MM by 1.25P	7/16"	5/16"	3/4"	5/8"	10.0
DS-65	18MM by 1.5P	7/16"	5/16"	15/16"	21/32"	11.0

Plugs - MP SERIES (Threaded — Machine Screw)

MATERIAL: Polyethylene

COLOR: Red

APPLICATION: Plugs will fit NS and NF Class 1-2-3 standard threads. Go-Gage only. Plugs are ribbed for easy handling. For flared and flareless fittings.

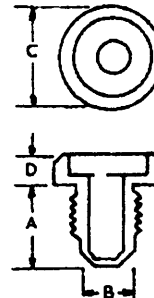

PART NO.	THREAD SIZE	A	B	C	D	WGT. PER M (IN LBS.)
MP-205	5/16"-24	15/32"	1/4"	9/16"	3/16"	1.1
MP-209	3/8"-24	1/2"	5/16"	5/8"	3/16"	1.4
MP-213	7/16"-20	9/16"	3/8"	11/16"	3/16"	1.9
MP-217	1/2"-20	9/16"	7/16"	3/4"	3/16"	2.6
MP-221	9/16"-18	9/16"	15/32"	13/16"	7/32"	2.9
MP-225	5/8"-18	5/8"	17/32"	7/8"	7/32"	3.1
MP-229	3/4"-16	21/32"	21/32"	1"	7/32"	3.3
MP-233	7/8"-14	3/4"	49/64"	1-1/8"	1/4"	7.5
MP-241	1-1/16"-12	7/8"	31/32"	1-3/8"	1/4"	8.4
MP-253	1-5/16"-12	15/16"	1-7/32"	1-5/8"	5/16"	18.4
MP-261	1-5/8"-12	31/32"	1-1/2"	1-7/8"	5/16"	22.8

Nylomatic

Screws, Nuts, Enclosures

Plugs FP Series (Threaded — Machine Screw)

MATERIAL: Polypropylene

COLOR: Red

APPLICATION: Plugs will fit NS and NF Class 1-2-3 standard threads. Go-gage only. Screw driver slot is provided.

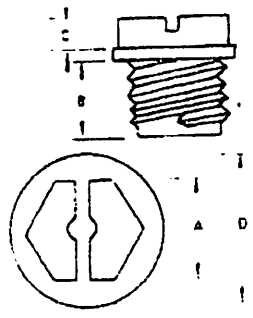

PART NO	THREAD SIZE	A	B	C	D	WGT PER M (IN LBS.)
FP-104	7-16-20	7-16"	30	3-16	5-8"	2.0
FP-108	9-16-18	1-2"	35	3-16	25-32"	3.0
FP-110	5-8-18	1-2"	46	3-16	43-64"	4.0
FP-115	3-4-16	11-16"	44	3-16	15-16"	6.0
FP-120	7-8-14	3-4"	50	1-4	1-1-16"	7.0
FP-122	1-14	3-4"	59	1-4	1-3-16"	8.0
FP-124	1-16-12	7-8"	62	1-4	1-5-16"	12.0
FP-125	1-16-14	7-8"	62	1-4	1-5-16"	12.0

(FP series available with O rings. Consult sales office.)

Plugs — P Series (Threaded — Pipe Thread — Hex Socket)

MATERIAL: Acetate

COLOR: Yellow

APPLICATION: Plugs will fit NPT standard pipe threads. These plugs can be inserted to give a flush fit.

PART NO	THREAD SIZE	A	#	WGT PER M (IN LBS.)
P-130	1-4	1-2"	1-4"	3.5
P-131	3-8	9-16"	5-16"	7.2
P-132	1-2	9-16"	3-8"	12.0
P-133	3-4	5-8"	9-16"	17.0
P-134	1-2	3-4"	5-8"	36.0
P-135	1-1-4	3-4"	3-4"	58.0
P-136	1-1-2	3-4"	3-4"	66.0

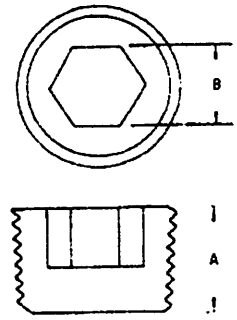

Nylomatic

Screws, Nuts, Enclosures

Plugs - P Series (Threaded - Pipe Thread - Short Head)

MATERIAL: Acetate

COLOR: Yellow

APPLICATION: Plugs will fit NPT standard pipe threads. Heads are knurled for easy handling. Screw driver slot is provided.

PART NO	THREAD SIZE	A	WGT PER Y (IN LBS)
P-212	1/8"	1.4"	.8
P-139	1/4"	3.8"	2.7

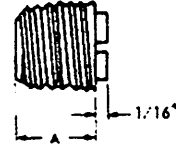

Plugs - P Series (Threaded - Pipe Thread - Shoulder Type)

MATERIAL: Acetate

COLOR: Yellow

APPLICATION: Plugs will fit NPT standard pipe threads, but are undersize to permit sealing on shoulder. Plugs are ribbed for easy handling. Screw driver slot is provided.

PART NO	THREAD SIZE	A	B	C	WGT PER Y (IN LBS)
P-543	1/2"	7/16"	3/8"	1-1/4"	13.0
P-544	3/4"	7/16"	3/8"	1-5/8"	30.0
P-545	1"	7/16"	3/8"	2"	34.0

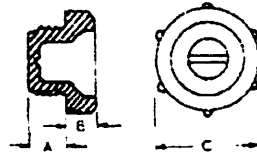

Nylomatic

Screws, Nuts, Enclosures

Plugs - MP Series (Threaded - Machine Screw)

MATERIAL: Acetate

COLOR: Yellow

APPLICATION: Plugs will fit NS and NF Class 1-2-3 standard threads. Go-Gage only. Plugs are ribbed for easy handling. Screw driver slot is provided. For flared and flareless fittings.

PART NO	THREAD SIZE	A	B	C	WGT PER M (IN LBS.)
MP-321	3/8"-24	13/32"	5/16"	9/16"	3.1
MP-322	7/16"-20	7/16"	3/8"	1-1/16"	4.1
MP-323	1/2"-20	7/16"	7/16"	3/4"	4.7
MP-324	9/16"-15	15/32"	1/2"	13/16"	5.4
MP-318	5/8"-18	1/2"	1/2"	7/8"	6.2
MP-325	3/4"-16	1/2"	5/8"	1"	7.2
MP-326	7/8"-14	5/8"	3/4"	1-1/8"	13.0
MP-327	1-1/16"-12	21/32"	15/16"	1-3/8"	13.2
MP-492	1-5/16"-12	1-1/16"	1-3/16"	1-5/8"	24.6
MP-501	1-5/8"-12	3/4"	1-7/16"	2-1/8"	36.0
MP-330	1-7/8"-12	27/32"	1-11/16"	2-3/8"	46.0

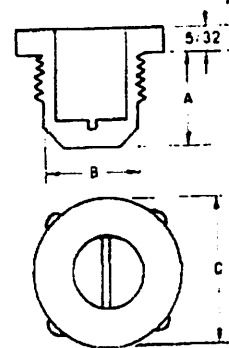

Plugs - MP Series (Threaded - Machine Screw)

MATERIAL: Acetate

COLOR: Yellow

APPLICATION: Plugs will fit NS and NF Class 1-2-3 standard threads except those marked with an asterisk (*) which fit NC threads only. Go-gage only. Plugs are knurled for easy handling. Screw driver slot is provided.

PART NO	THREAD SIZE	A	B	C	WGT PER M (IN LBS.)
MP-72	5/16"-24	5/16"	11/32"	1/2"	2.6
MP-363	3/8"-16	5/16"	11/32"	5/8"	3.5
MP-70	3/8"-24	5/16"	11/32"	5/8"	3.5
MP-75	7/16"-14	5/16"	3/8"	1-1/16"	4.3
MP-73	7/16"-20	5/16"	3/8"	1-1/16"	4.3
MP-74	7/16"-24	5/16"	3/8"	1-1/16"	4.3
MP-531	1/2"-13	3/8"	3/8"	7/8"	5.0
MP-76	1/2"-20	3/8"	3/8"	3/4"	5.5
MP-78	9/16"-18	3/8"	3/8"	13/16"	6.1
MP-358	5/8"-11	3/8"	3/8"	7/8"	8.5
MP-80	5/8"-18	3/8"	3/8"	7/8"	8.5
MP-211	5/8"-24	3/8"	3/8"	7/8"	8.5
MP-493	5/8"-27	3/8"	3/8"	7/8"	7.7
MP-245	11/16"-16	3/8"	3/8"	15/16"	10.5
MP-359	3/4"-10	3/8"	11/32"	1"	10.7
MP-81	3/4"-16	3/8"	11/32"	1"	10.7
MP-82	3/4"-18	3/8"	11/32"	1"	10.7
MP-88	7/8"-14	3/8"	11/32"	1-1/16"	12.0
MP-90	7/8"-18	3/8"	11/32"	1-1/16"	12.0
MP-246	7/8"-20	3/8"	11/32"	1-1/16"	12.0
MP-361	1"-8	3/8"	11/32"	1-3/16"	13.5
MP-92	1"-4	3/8"	11/32"	1-3/16"	13.5
MP-523	1"-18	3/8"	11/32"	1-1/4"	13.6
MP-93	1-1/16"-12	3/8"	11/32"	1-1/4"	14.6
MP-95	1-1/8"-12	3/8"	11/32"	1-5/16"	16.9
MP-98	1-5/16"-12	3/8"	11/32"	1-1/2"	25.5
MP-223	1-5/8"-12	1/2"	11/32"	1-7/8"	41.0
MP-219	1-7/8"-12	1/2"	11/32"	2-1/8"	56.0

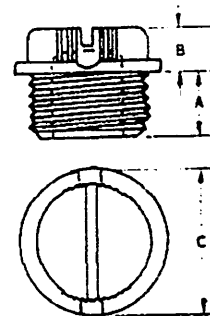

Nylomatic

Screws, Nuts, Enclosures

Plugs – PP Series (Non-Threaded — Push-In)

MATERIAL: Polyethylene

COLOR: Yellow

APPLICATION: Designed to plug threaded holes. Easily inserted by push-in pressure, yet will not vibrate loose.

PART NO	TO FIT S.A.E. THREAD SIZE	TO FIT NPT THREAD SIZE	A	B	C
PP1/4	1/4"	—	.56	.78	.33
PP5/16	5/16"	—	.56	.25	.33
PP3/8	3/8"	1/8"	.65	.31	.34
PP7/16	7/16"	—	.74	.36	.34
PP1/2	1/2"	1/4"	.74	.43	.36
PP9/16	9/16"	—	.84	.48	.36
PP5/8	5/8"	3/8"	.90	.55	.37
PP3/4	3/4"	—	.90	.66	.38
PP7/8	7/8"	—	1.16	.77	.38
PP1	1"	3/4"	1.25	.88	.39
PP1-1/16	1-1/16"	—	1.43	.95	.40

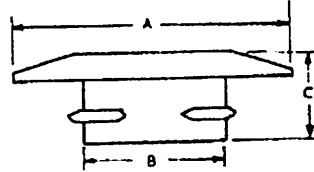

Plugs – SM Series (Non-Threaded — Sheet Metal)

MATERIAL: Elastic Polyethylene

COLOR: Black

APPLICATION: Used for plugging access holes in equipment made of sheet metal.

PART NO.	HOLE SIZE	A	B	C	D	WGT. PER M (IN LBS.)
SM-38	3/8"	.25	.74	.40	.24	\$.21
SM1/2	1/2"	.25	.90	.55	.36	1.55
SM3/4	3/4"	.25	1.12	.81	.61	2.64
SM7/8	7/8"	.25	1.25	.94	.73	3.09
SM1	1"	.25	1.43	1.06	.88	4.19
SM1-1/4	1-1/4"	.25	1.62	1.32	1.12	4.85

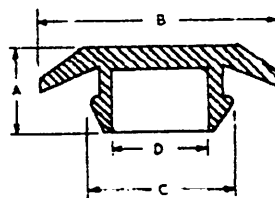

Nylomatic